



# MONTANA FISH, WILDLIFE & PARKS

## ADDENDUM NO. 1

---

TO: ALL BIDDERS OF RECORD

PROJECT: John Owen Fishing Access Site

FWP PROJECT #: 7173727

DATE: January 16, 2025

FROM: Missoula Engineering, LLC

**Acknowledge receipt of this addendum by inserting its number and date in the Proposal Form and on the Bid Envelope. Failure to do so may subject bidder to disqualification.**

This Addendum forms a part of the Contract Documents. Clarification and/or modifications area as follows:

1. **Replacement of Bid Proposal Form:** Please replace the previously distributed Bid Proposal Form with the revised form attached hereto. This revision corrects a clerical error that occurred during the uploading process to the Montana Fish, Wildlife & Parks website. The errors included incorrect quantities and units of measurement. Additionally, the following changes have been made:
  - o Removal of the items for concrete removal.
  - o Addition of picnic benches and their installation.
  - o An update to the quantity of asphalt trail.
2. **Manufacturer and Model:** Picnic tables shall be Pilot Rock XT Series HD 8 foot pipe frame (hot dipped galvanized finish) or approved equal (frame only, wood to supplied by FWP).
3. **Manufacturer and Model:** Fire Rings shall be Pilot Rock FA-30, 11"- 3/8" sides (hinge type mount) or approved equal.
4. **Update note on drawings:** On drawing sheet 2 update construction note #6 to reflect the current 7<sup>th</sup> edition of the Montana Public Works Standards and Specifications.
5. **Remove note on drawings:** On drawing sheet 7 removed "Misc. concrete to be removed (see pay item #210)". Please find attached a revised plan set.

**END OF ADDENDUM NO. 1**

PROPOSAL – **ADDENDUM #1**

Montana Fish, Wildlife & Parks  
Design & Construction  
P.O. Box 200701  
1522 Ninth Avenue  
Helena, Montana 59620-0701

Project Name: John Owen FAS Site Development

FWP Project #: 7173727

The undersigned, having familiarized themselves with the conditions of the work and the contract documents as prepared by Missoula Engineering, LLC; P.O. Box 2833, Missoula, MT 59806; (406) 215-1555, agrees to furnish all labor, materials, equipment, and services necessary to complete all general construction work, as bid herein, for a project entitled John Owen FAS Site Development in accordance with the Contract Documents including all Addenda. The bidder agrees to perform all the work described below at the price shown as follows:

**Reminder to Contractors: All Unit Prices must be filled in on the Bid Form for a valid bid (18-2-303 MCA).**

**Base Bid:**

Item #	Description	Estimated Quantity	Unit Measure	Unit Price	Amount
1	Mobilization/Demobilization	1	LS		
2	Traffic Control	1	LS		
3	Erosion Control	1	LS		
4	Clearing and Grubbing	1	LS		
5	Excavation and Embankment	1	LS		
6	Import Embankment Material	1000	CY		
7	Soil Fabric	5140	SY		
8	Gravel Road Surfacing	5140	SY		
9	Road Reconditioning	3148	SY		
10	Gravel Trail Surfacing	132	SY		
11	Paved Trail Surfacing	76	SY		
12	Steel Pipe Gate	1	LS		
13	Panel Gate	1	LS		
14	Guardrail Installation	150	LF		
15	Guardrail Terminal Section	1	LS		

Contractor Name: \_\_\_\_\_

**PROPOSAL – ADDENDUM #1**

16	Remove Existing Wire Fencing	930	LF		
17	Perimeter Fencing – 5 Strand Barbed Wire	985	LF		
18	Perimeter Fencing – 2 Stand Barbed Wire with Field Fence	443	LF		
19	Wood Post and Rail Fencing	490	LF		
20	Pin Down Curbs	41	EA		
21	Signage	7	EA		
22	Relocate Existing Sign	3	EA		
23	Picnic Benches and Installation	4	EA		
24	Steel Fire Pits and Installation	4	EA		
25	Striping	1	LS		
26	Install and Provide Latrine	1	LS		

Total: \$ \_\_\_\_\_

**TOTAL BID:**

\_\_\_\_\_ and \_\_\_\_/DOLLARS (\$\_\_\_\_\_)

Contractor Name: \_\_\_\_\_

**PROPOSAL – ADDENDUM #1**

**And certifies that they are a duly and regularly licensed contractor registered with the  
Montana Department of Labor and Industry:**

FIRM NAME: \_\_\_\_\_

TELEPHONE #: \_\_\_\_\_ FAX#: \_\_\_\_\_

BY: \_\_\_\_\_

REGISTRATION # : \_\_\_\_\_

BUSINESS ADDRESS: \_\_\_\_\_

FEIN #: \_\_\_\_\_

E-MAIL ADDRESS: \_\_\_\_\_

DATE: \_\_\_\_\_

**This bidder acknowledges receipt of the following addenda:**

ADDENDUM NO. \_\_\_\_\_ DATED: \_\_\_\_\_

ADDENDUM NO. \_\_\_\_\_ DATED: \_\_\_\_\_

ADDENDUM NO. \_\_\_\_\_ DATED: \_\_\_\_\_

Contractor Name: \_\_\_\_\_

**CONSTRUCTION NOTES:**

1. THE CONTRACTOR SHALL NOTIFY THE ENGINEER IMMEDIATELY SHOULD ANY CONFLICTS EXIST BETWEEN THE PLANS AND WHAT IS FOUND IN THE FIELD.
2. IT IS THE CONTRACTOR'S RESPONSIBILITY TO VERIFY AND PROTECT ALL UTILITY LINES. IT IS THE CONTRACTOR'S RESPONSIBILITY TO NOTIFY THE ONE CALL UTILITY LOCATION CENTER AT 1-800-424-5555 AT LEAST 2 BUSINESS DAYS PRIOR TO PERFORMING ANY EXCAVATION.
3. IT IS THE CONTRACTOR'S RESPONSIBILITY TO OBTAIN ALL NECESSARY PERMITS, (AT THEIR EXPENSE) REQUIRED TO PERFORM THE WORK. THESE PERMITS INCLUDE, BUT ARE NOT LIMITED TO THE FOLLOWING: RAVALLI COUNTY AND STATE OF MONTANA PERMITS.
4. ALL WORK SHALL BE COMPLETED IN A SAFE MANNER AND CONSISTENT WITH O.S.H.A GUIDELINES.
5. CONTRACTOR SHALL PROTECT ALL ADJACENT IMPROVEMENTS FROM DAMAGE AND EROSION. DISTURBED AREAS SHALL BE RESTORED TO THE ORIGINAL CONDITION OR TO THE PROPOSED DESIGN GRADE AS INDICATED ON THE PLANS.
6. ALL CIVIL CONSTRUCTION SHALL BE IN ACCORDANCE WITH THE FOLLOWING CODES AS APPLICABLE: MONTANA PUBLIC WORKS STANDARD SPECIFICATIONS 7TH EDITION AND INTERNATIONAL BUILDING CODE. IN INSTANCES WHERE A CONFLICT EXISTS BETWEEN THE REFERENCED CODES CONTACT THE ENGINEER. THE MOST STRINGENT CODE SHALL RULE.
7. ALL REQUIRED COMPACTION TESTING SHALL BE PROVIDED BY AN INDEPENDENT TESTING FIRM AT THE EXPENSE OF THE CONTRACTOR.
8. IMPORT MATERIAL REQUIRED TO COMPLETE EARTHWORK SHALL BE IMPORTED FROM OFF-SITE OR DETERMINED TO BE SUITABLE BY SUPPLYING INDEPENDENT TESTING OF MATERIAL AND AFTER INSPECTION BY ENGINEER AND WRITTEN APPROVAL BY THE OWNER. CONTRACTOR IS RESPONSIBLE FOR SOURCING AND DELIVERY OF ALL IMPORTED FILL MATERIAL AND SHALL BE CONSIDERED INCIDENTAL TO THE WORK. ALL IMPORT MATERIAL SHALL BE CLEAN MATERIAL FREE OF DEBRIS AND SUITABLE FOR USE AS STRUCTURAL FILL.
9. ALL WORK WITHIN THE MDT ROW SHALL BE IN CONFORMANCE WITH MDT STANDARDS AND REGULATIONS INCLUDING BUT NOT LIMITED TO RE-VEGETATION.
10. WATER NECESSARY FOR CONSTRUCTION ACTIVITIES SHALL BE PROVIDED BY THE CONTRACTOR AND CONSIDERED INCIDENTAL TO THE WORK. ALL PERMITTING FOR USE OF ANY ON-SITE WATER SHALL BE THE SOLE RESPONSIBILITY OF THE CONTRACTOR.

**SURVEY NOTES:**

1. SURVEY DATUM:  
HORIZONTAL - STATE PLANE, NAD 83  
VERTICAL - NAVD 88
2. SURVEY INFORMATION SHOWN ON DRAWINGS ARE BASED UPON LIMITED SURVEY DATA. EXISTING CONDITIONS MAY VARY FROM THOSE SHOWN. CONTRACTOR IS RESPONSIBLE FOR VERIFYING EXISTING CONDITIONS PRIOR TO BEGINNING CONSTRUCTION.
3. CONTRACTOR SHALL MAINTAIN OR REPLACE ANY EXISTING SURVEY MONUMENTS, CONTROL POINTS, AND STAKING. REPLACEMENT COSTS SHALL BE THE SOLE RESPONSIBILITY OF THE CONTRACTOR AND SHALL BE COMPLETED BY A LICENSED SURVEYOR IN THE STATE OF MONTANA.

**CONSTRUCTION STAKING NOTES:**

1. STAKING WILL BE THE RESPONSIBILITY OF THE CONTRACTOR FOR SCHEDULING AND PAYMENT

**LEGEND**

EXISTING		PROPOSED		PROPERTY LINE	EXISTING	PROPOSED	BOLLARD
				PROPERTY LINE			BOLLARD
				EASEMENT			SIGN
				CENTERLINE			MAILBOX
				EDGE OF ROAD			WATER VALVE
				MAJOR CONTOUR			WATER METER
				MINOR CONTOUR			FIRE HYDRANT
				WATER MAIN			MONITORING WELL
				WATER SERVICE			POTABLE WATER WELL
				SEWER MAIN			BLOW-OFF ASSEMBLY
				SEWER SERVICE			SEWER MANHOLE
				SEWER FORCE MAIN			SEWER CLEAN-OUT
				CURB			SEPTIC TANK
				FENCE			STORMWATER SUMP
				OVERHEAD POWER LINE			TEST PIT
				UNDERGROUND POWER LINE			ELECTRIC METER
				UNDERGROUND GAS LINE			TELEPHONE RISER
				UNDERGROUND TELEVISION LINE			TELEPHONE MANHOLE
				UNDERGROUND TELEPHONE LINE			LIGHT POLE
				UNDERGROUND FIBER OPTIC LINE			CATV RISER
				UNDERGROUND IRRIGATION LINE			GAS METER
				STORMWATER SWALE			GAS VALVE

\* THIS IS A STANDARD LEGEND, NOT ALL SYMBOLS MAY BE USED OR SHOWN ON THIS PROJECT \*

**DETAIL CALLOUT**

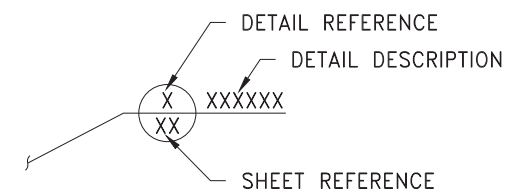

**HATCH LEGEND**

	TYPICAL GRAVEL SECTION
	ROAD RECONDITIONING
	BANK RESTORATION
	RIVER ACCESS

JLS 01/03/25  
DRAWN BY: DATE:  
JWS 01/03/25  
CHECKED BY: DATE:

JLS 01/03/25  
REVISED BY: DATE:  
JWS 01/03/25  
APPROVED BY: DATE:

APPROVED BY: DATE:  
APPROVED BY: DATE:



**MONTANA FISH,  
WILDLIFE & PARKS**

**GENERAL NOTES AND LEGEND**  
JOHN OWEN FAS FWP #7173727

A#1



SHEET: 2 of 20

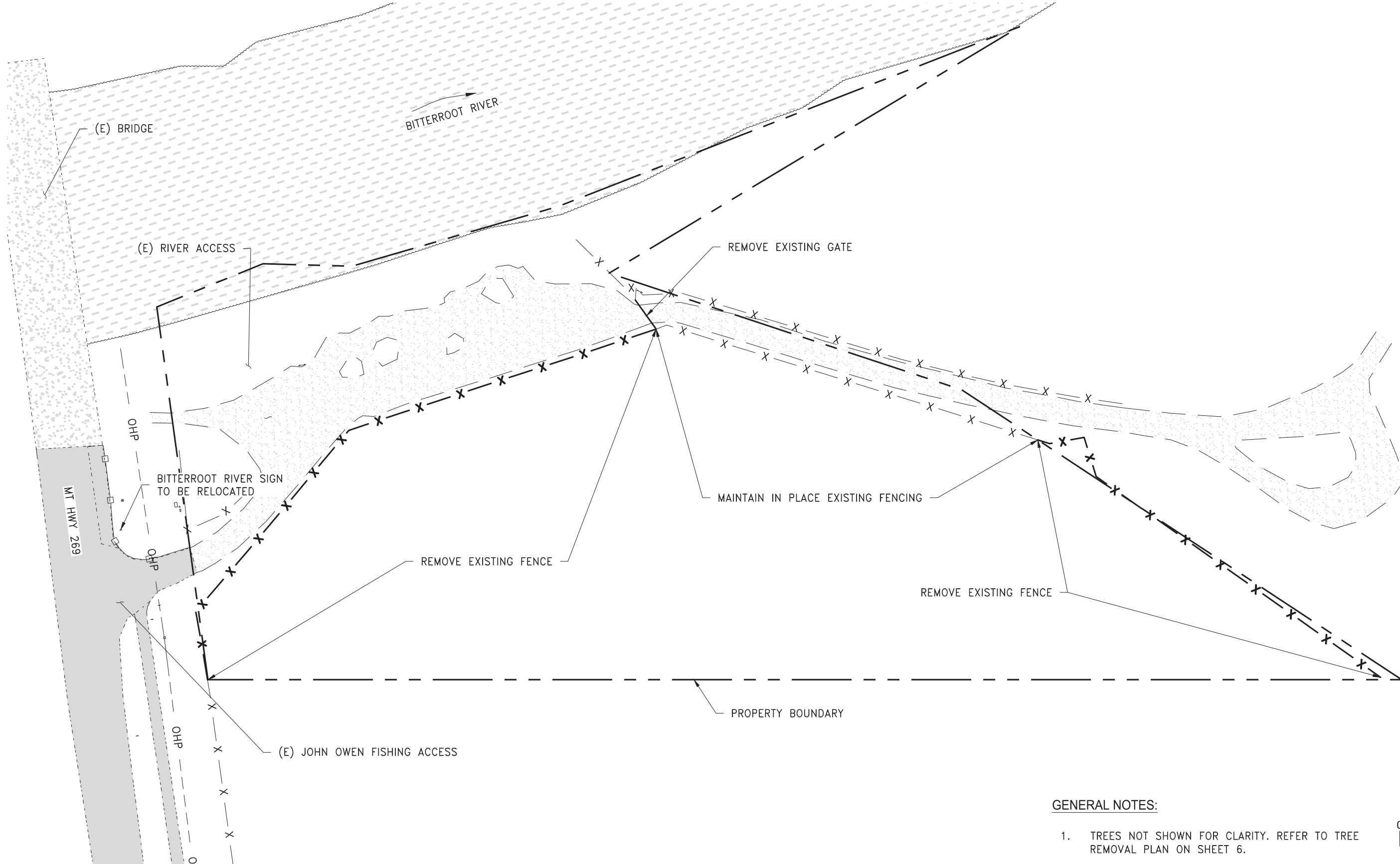

**GENERAL NOTES:**

1. TREES NOT SHOWN FOR CLARITY. REFER TO TREE REMOVAL PLAN ON SHEET 6.

JLS  
DRAWN BY:  
DATE: 01/03/25

JLS  
REVISED BY:  
DATE: 01/03/25

APPROVED BY: \_\_\_\_\_ DATE: \_\_\_\_\_

JWS  
CHECKED BY:  
DATE: 01/03/25

JWS  
APPROVED BY:  
DATE: 01/03/25

APPROVED BY: \_\_\_\_\_ DATE: \_\_\_\_\_



**MONTANA FISH,  
WILDLIFE & PARKS**  
201

**DEMOLITION PLAN**  
JOHN OWEN FAS FWP #7173727

A#1



SHEET: 7 of 20